



FUNCTIONS
THE DRIVE

DRIVE

WELCOME

to your function at The Drive

Fresh from a \$44m redevelopment, The Drive is back with a new story to tell. Situated in the vibrant heart of the Riverbank precinct, The Drive is Adelaide's only open-aired undercover music, sporting, events and function venue.

The Courtside Room is the newest function space in Adelaide and offers a premium viewing experience overlooking the East of the City to the Adelaide Hills, and the beautiful Riverbank.

The unique architecture boasts floor to ceiling glass windows to the East and exclusive access to Centre Court to the West. The modern layout and room offerings will elevate your brand, allowing you to entertain like never before.

The Courtside Room at The Drive is perfect for banquets, networking functions, conferences and weddings. The connecting intimate Premier Suite can complement this space as an ideal VIP, board or smaller function space, and the undercover championship-sized tennis courts have endless opportunities for something more bespoke.

FUNCTION FACILITIES

- ◆ Separate Premier Suite
- ◆ Shared kitchenette and bar access
- ◆ Catering options available
- ◆ Branding throughout venue

ADDITIONAL FACILITIES

- ◆ Performer green room
- ◆ Gym facilities
- ◆ Multiple workspaces

AV EQUIPMENT

- ◆ Handheld and lapel microphones
- ◆ Surround sound
- ◆ 4K projector
- ◆ 140" screen
- ◆ Multiple display screens

MEMBERSHIPS

To find out more about The Drive's membership opportunities, please contact Andrew Fitzgerald: AFitzgerald@Tennis.com.au



OUR SPACES

THE COURTSIDE ROOM

The Courtside Room provides a premium viewing experience combined with a unique intimacy, allowing you to take your function to the next level.

You will also have access to the quality catering offerings and modern facilities.

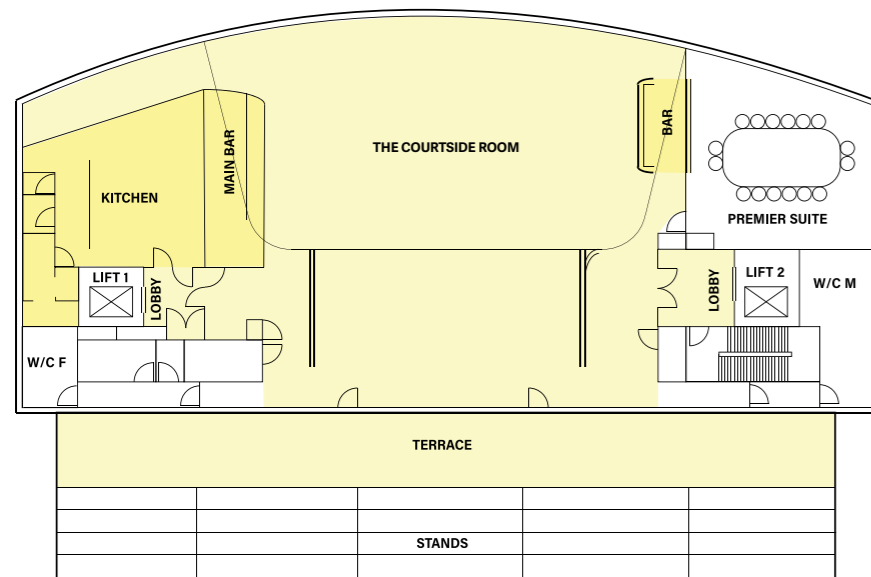

FEATURES

- 350m² floor area
- 140 banquet seating
- 130 cabaret seating
- 140 theatre seating
- 300 cocktail standing
- Disabled access

PREMIER SUITE

Elevate your corporate networking and meeting opportunities in the Premier Suite.

Allow our modern office facilities to seamlessly complement your brand, reputation and client experience.

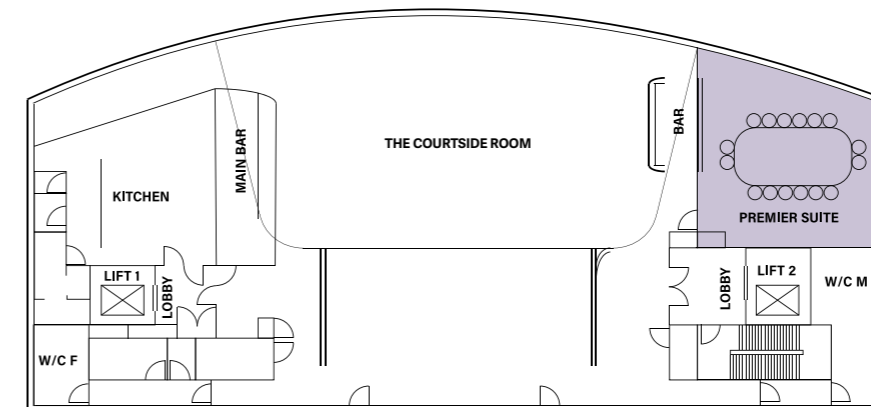

FEATURES

- 63m² floor area
- 40 theatre seating
- 16 boardroom seating
- 50 cocktail standing
- 16 U shaped seating
- Disabled access





THE COURTSIDE ROOM WITH COURT

Are you after the ultimate function experience? The Courtside Room with Court package includes access to a formal function space

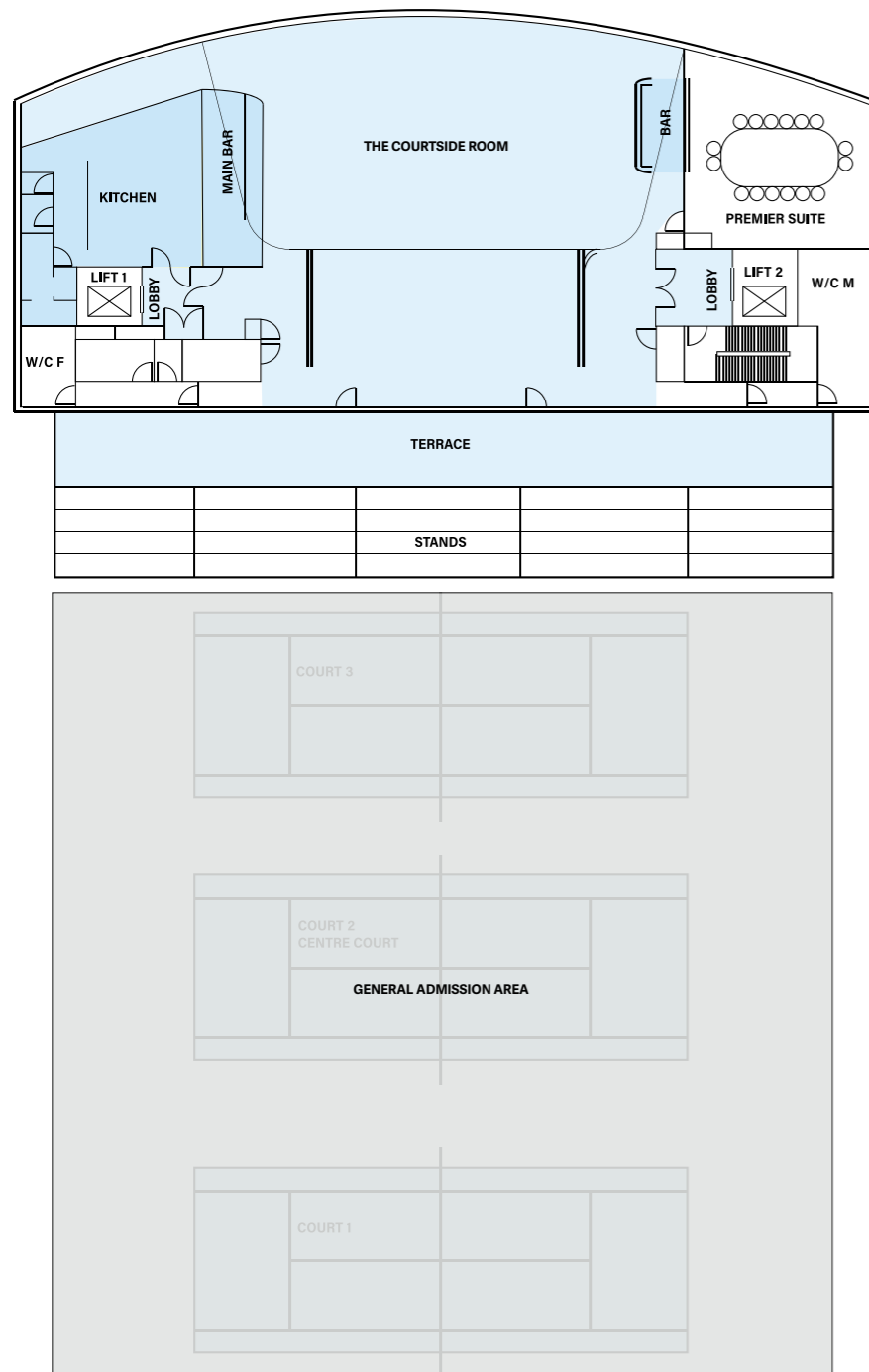
and three championship-sized tennis courts, able to be transformed into a 1000+ person capacity function with the layout of your choosing.



FEATURES

-  2240m² floor area
-  1000 banquet seating
-  2260 theatre seating
-  1500 cocktail standing
-  Disabled access

VENUE MAP

6800 maximum venue capacity

ADELAIDE OVAL

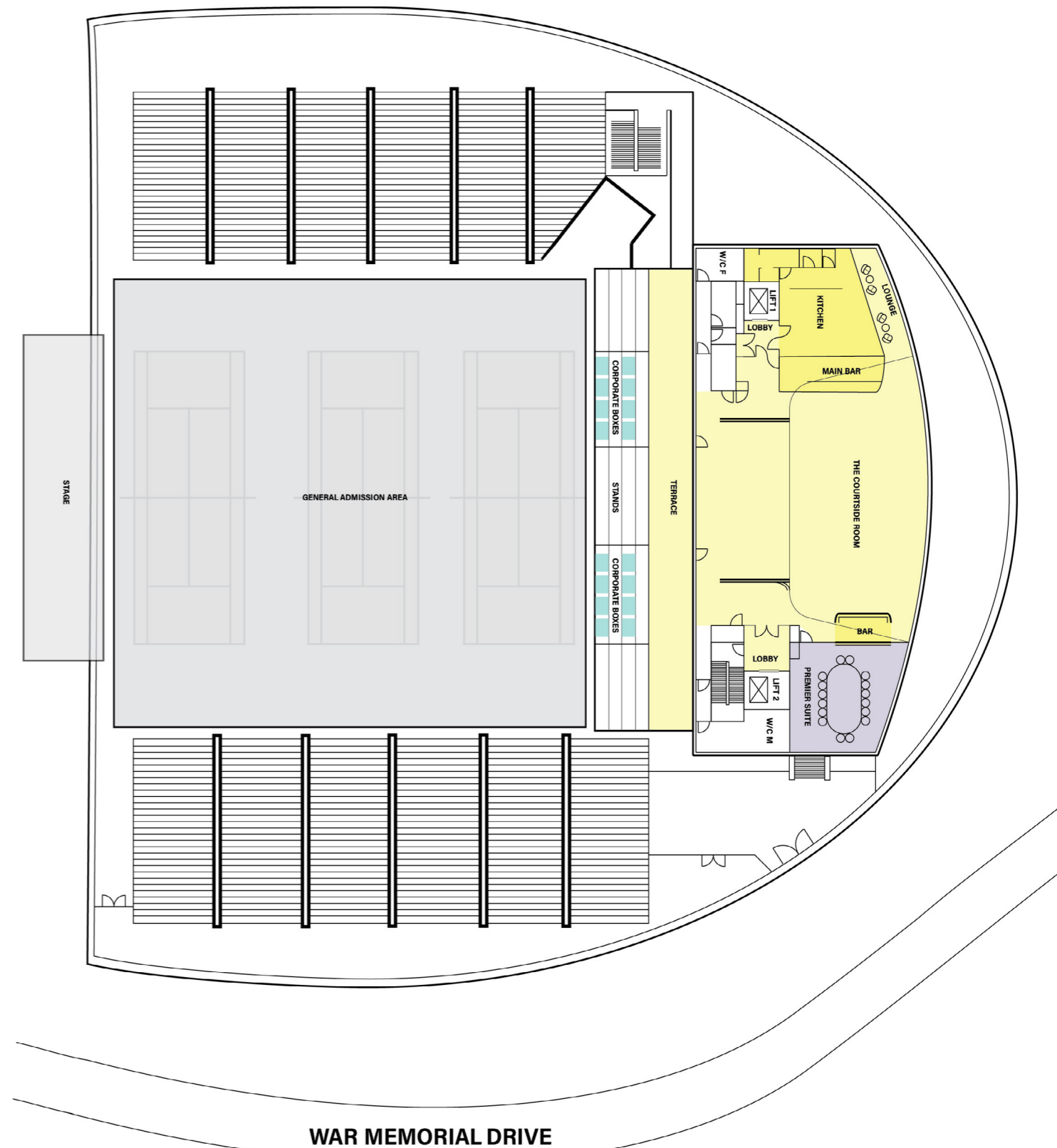

WIT DRIVE

CONTACT our function partners | Adelaide Venue Management

t. 8210 6677

e. sales@avmc.com.au

War Memorial Drive, North Adelaide SA 5006

