

**Weddings**

**W  
I  
T  
H  
D  
R  
I  
V  
E**

# Welcome to The Drive

*Begin your forever  
at The Drive.*



The Drive congratulates you on your engagement and welcomes you to enjoy the reception planning process in the hands of our expert wedding planners.

Situated in the vibrant heart of Adelaide, The Courtside Room is the perfect space to celebrate your wedding, overlooking the Riverbank and within close proximity to a range of accommodation and the city centre.

The unique space offers views across the East of the City to the Adelaide Hills and overlooks the beautiful Riverbank.

Our custom wedding packages feature inspired menus, décor and room set-ups allowing you to celebrate your big day in style.

***We look forward to hosting  
you at The Drive.***









**Packages**



## Silver

\$165.00

Three-course meal comprising of set entrée, main and dessert. Five-hour Classic beverage package including sparkling, white and red wines, beer, soft drink, tea and coffee.

## Gold

\$175.00

Three-course meal comprising of set entrée, alternately placed main and set dessert. Five-hour Classic beverage package including sparkling, white and red wines, beer, soft drink, tea and coffee.

## Diamond

\$195.00

Chef's selection of three canapés. Three-course meal comprising of set entrée, alternately placed main and set dessert. Five-hour Classic beverage package including sparkling, white and red wines, beer, soft drink, tea and coffee.

Prices are inclusive of GST and may be subject to change.  
Where not otherwise listed, pricing is per person.  
All prices are valid for events held up to 30 June 2026.



# The Courtside Room

Overlooking the East of the City, The Courtside Room provides a premium viewing experience combined with a unique intimacy, allowing you to host your dream wedding.

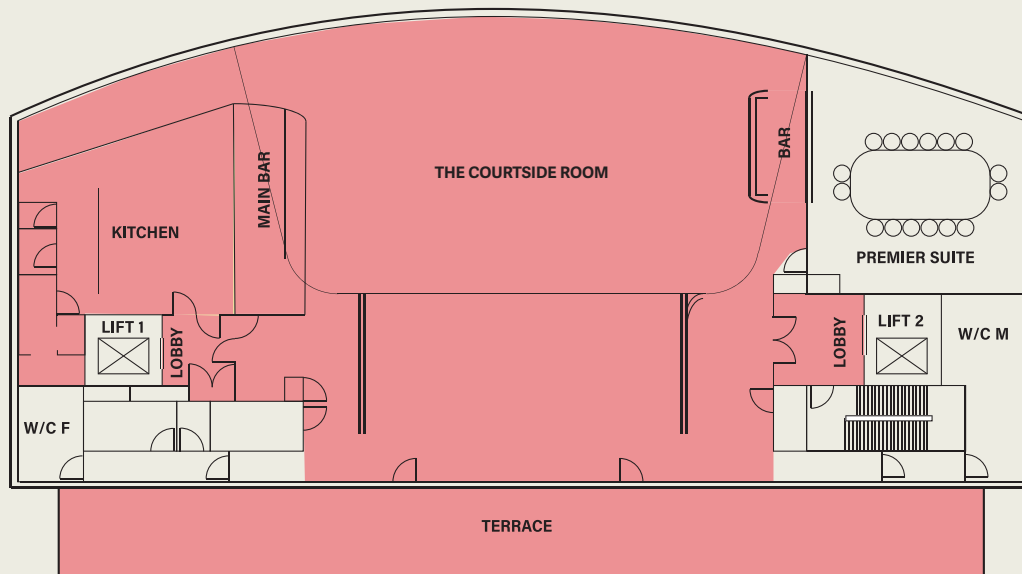

350m<sup>2</sup> floor area



140 theatre seating



140 banquet seating



250 cocktail standing



120 cabaret seating



Disabled access

## Package Inclusions

- ◆ Dance floor and cake table
- ◆ White linen table cloths
- ◆ White or black chair covers
- ◆ Linen napkins in your choice of colour
- ◆ Two personalised menus on each table
- ◆ Digital and directional signage
- ◆ Private change room for entertainers
- ◆ Stage with lectern and microphone
- ◆ Red carpet at entry
- ◆ Cutting and serving cake

## Optional Extras

Enhance your wedding with one of the following.

Please contact your Event Planner for additional information and pricing.

- ◆ Antipasto platters
- ◆ Seafood platters
- ◆ Beverage package upgrade
- ◆ Spirits package





[View the food and beverage menu here.](#)







# WIT DRIVE

**War Memorial Drive, North Adelaide SA 5006**

Contact our wedding partners Adelaide Venue Management  
[sales@avmc.com.au](mailto:sales@avmc.com.au)